

# NorthLink WA Traffic Update

## Temporary upgrade of Tonkin/Reid Highway intersection Roundabout to replace traffic signals

Great Northern Connect (GNC), a joint venture between BGC Contracting and Laing O'Rourke is working in partnership with Main Roads to deliver NorthLink WA central section.

### What's happening at Tonkin/Reid Highway intersection?

NorthLink WA central section involves building WA's largest freeway-to-freeway interchange at the Tonkin/Reid Highway intersection. The interchange will be free-flowing, providing a safer and quicker route for motorists.

From August, the first two bridges on Reid Highway between Beechboro Road North and Tonkin Highway will open to traffic, and a temporary roundabout will replace traffic lights at the Tonkin/Reid Highway intersection.

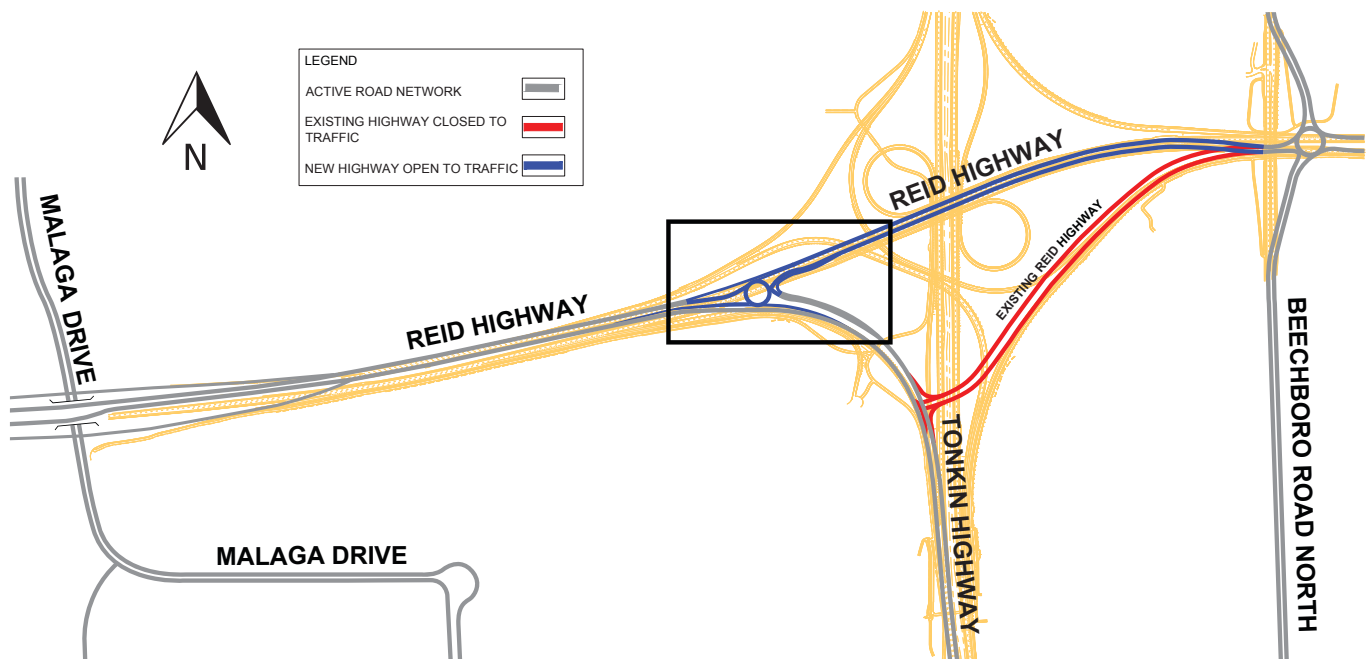

### How will impacts to traffic be managed?

Construction of the roundabout will involve some night works, together with lane closures during off-peak times. Once open, the temporary roundabout is expected to deliver an improvement in intersection performance. It will remain in place until mid-2019.

### What are the benefits of a temporary roundabout?

The roundabout will minimise inconvenience to motorists by improving traffic flow through the intersection. It will also allow for vital construction works to continue to complete the new interchange without impacting motorists.



Australian Government



mainroads  
WESTERN AUSTRALIA

## Thanks for your patience

If you travel through roadworks along NorthLink WA, slow down and enjoy the ride – the benefits will be worth it. Your patience and cooperation is appreciated while we undertake these vital works.

The \$1.02 billion NorthLink WA initiative is jointly funded by the Australian (\$821m) and Western Australian (\$204m) governments.

## Changed traffic conditions from Sunday 12 August:

- Motorists who travel east on Reid Highway will bypass the roundabout
- Motorists who travel south onto Tonkin Highway from Reid Highway (west) enter the roundabout and take the second exit onto Tonkin Highway
- Motorists who travel west on Reid Highway enter the roundabout and take the first exit onto Reid Highway
- Motorists who travel south onto Tonkin Highway, from Reid Highway (east) use the slip lane and will bypass the roundabout
- Motorists heading towards Midland from Tonkin Highway (south), enter the roundabout and take the second exit onto Reid Highway
- Motorists who travel west onto Reid Highway from Tonkin Highway (south) will bypass the roundabout

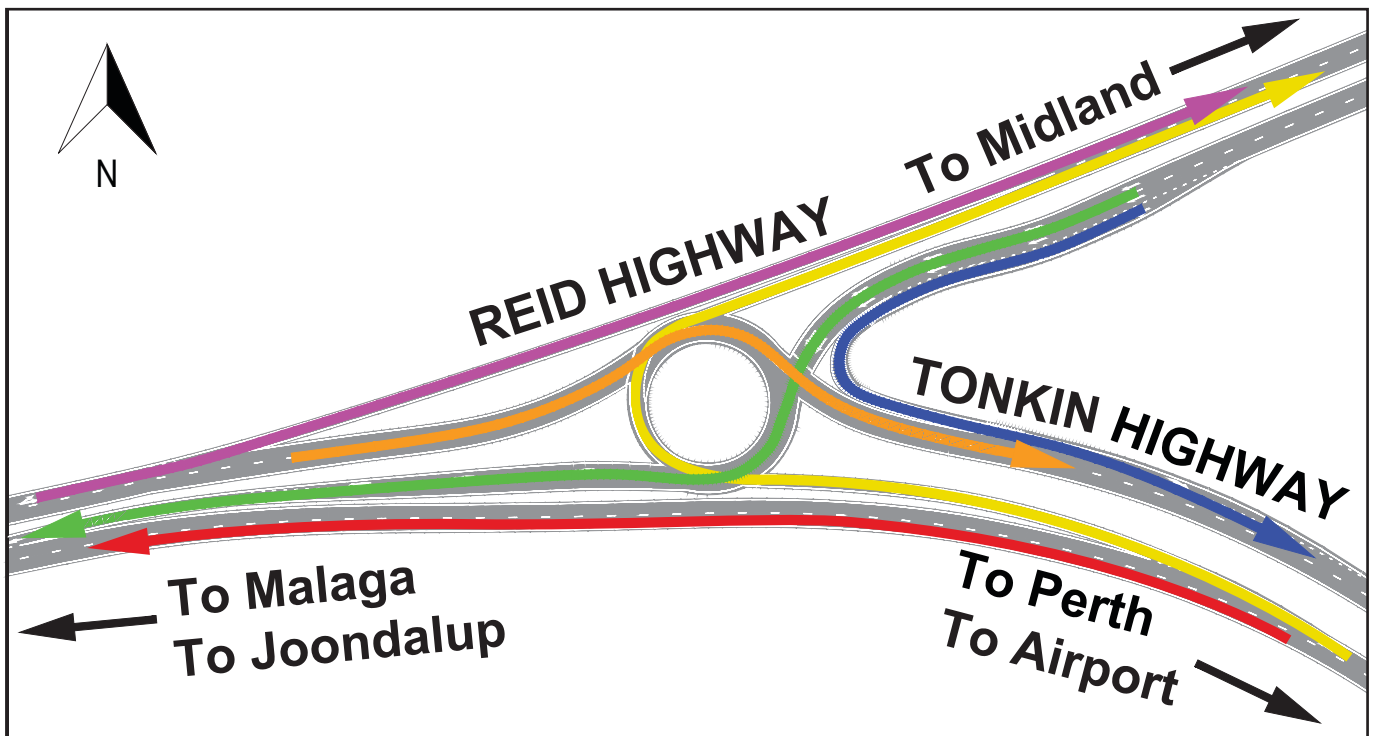

## Where can I find out more information?

Sign up to receive traffic and construction updates by emailing [info@gncjv.com.au](mailto:info@gncjv.com.au). You can find out more information about NorthLink WA at [www.northlinkwa.com.au](http://www.northlinkwa.com.au) or FREE CALL anytime on 1800 874 998.

Join us on Facebook at [www.facebook.com/groups/northlinkwa](http://www.facebook.com/groups/northlinkwa) or search NorthLink WA Community Group.



Australian Government



mainroads  
WESTERN AUSTRALIA

**BUILDING OUR FUTURE**